

## Getting to Full-Text Journals at Home

1. Go to:  
<https://ovidts.com/shibboleth?entityID=https%3A%2F%2Fidp.eduserv.org.uk%2Fopenathens>

2. You may be prompted to login.

Sign in with an OpenAthens account

Username  
Email address or username

Password  
Password

Sign in

[Problems signing in?](#)

Find your institution

Search  
Type the name of your institution

Type "Gundersen" under Find your institution. Click on the Gundersen Health System link.

3. Click Gundersen Health System-Current Employees if you are a current, salaried employee. Sign in with your Gundersen email and current network password.
4. Click Open Athens-Sign in with an OpenAthens account if library staff assigned an OpenAthens account to you. Sign in with your OpenAthens username/password.

Choose how to sign in

Gundersen Health System - Current Employees  
Sign in at Gundersen Health System

OpenAthens  
Sign in with an OpenAthens account

Current Gundersen Health System Employees

For those assigned an OpenAthens account.

5. "Gundersen Health System-Current Salaried Employees" will see this screen:

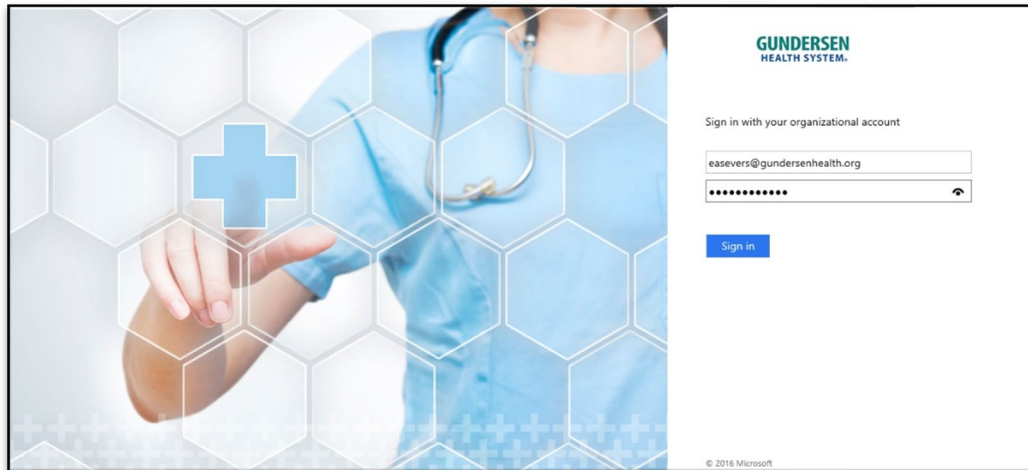

6. Current salaried employees--sign in with your Gundersen email and current network password.
7. After signing in, you will be redirected to the Library's home page.
8. Under Library eResources, click on Journals.

Adolf L. Gundersen, MD  
Health Sciences Library

Home Search Everything Browse Journals, Books or Databases Citation Matcher

**Popular Resources**  
ClinicalKey  
LexiComp  
PubMed  
CINAHL  
Library Catalog  
Books  
More resources

**Popular Subjects**  
Nursing  
Resources for Residents  
Writing and Publishing  
Continuing Education  
More subjects

**Search Everything:** articles, ebooks, journals, our website, and more.

Enter keywords

[Search Settings](#) | [Bookmarks](#) | [Saved Searches](#) [Advanced Search](#)

[Tips and Tricks for Using the Search Everything Tool](#)

**Library eResources:** search for items available from GHS Library Services.

All Journals eBooks Databases ...

Search: e.g. Nature OR (title:Nature OR issn:1234-12...

[Advanced Search](#)

Browse by Subject:

Browse by letter:

0-9	A	B	C	D	E	F	G	H	I
J	K	L	M	N	O	P	Q	R	S
T	U	V	W	X	Y	Z	All		

9. Search for the journal of interest. For example, New England Journal of Medicine.

**Library eResources:** search for items available from GHS Library Services.

All Journals eBooks Databases

Search:  [Search](#)

[Advanced Search](#)

Browse by Subject:  [Browse](#)

Browse by letter:

0-9	A	B	C	D	E	F	G	H	I
J	K	L	M	N	O	P	Q	R	S
T	U	V	W	X	Y	Z		All	

10. Click on the link for the journal.

 **New England Journal of Medicine ( NEJM )**  
Massachusetts Medical Society

**Access Information:**

[Massachusetts Medical Society](#) 01/1990 - Current

Gundersen Print Journals 01/1971 - Current

**Notes:** Volumes 284-335/336IN/337--, 1971-

**ISSN (print):** 0028-4793  
**ISSN (electronic):** 1533-4406

[🔔 Activate Journal Alert](#) | [⭐ Bookmark](#)

11. First, look for a link marked OpenAthens. The OpenAthens link allows you to use your GHS login to access library resources.

12. If an OpenAthens link is not present, look for a Sign In button which will take you to an OpenAthens link. Each journal website will be different. A few examples are shown below.

NEJM Group - Follow Us - [Sign in](#) [Create Account](#) [SUBSCRIBE](#)

 The NEW ENGLAND JOURNAL of MEDICINE

[SUBSCRIBE OR RENEW](#) → 

Additional examples:

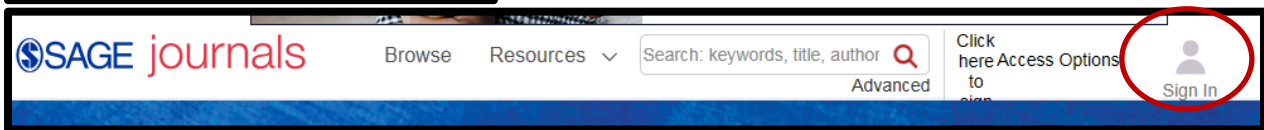
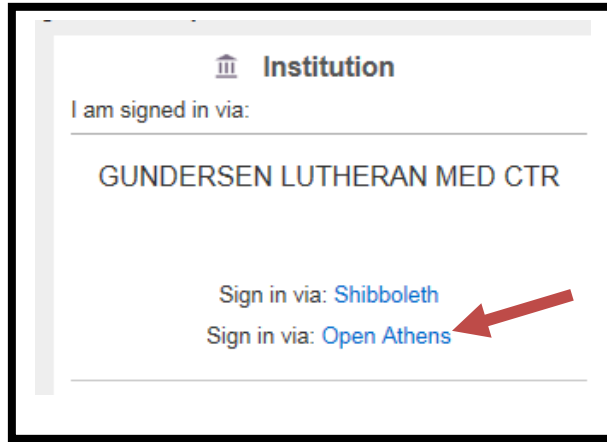
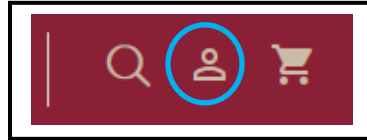
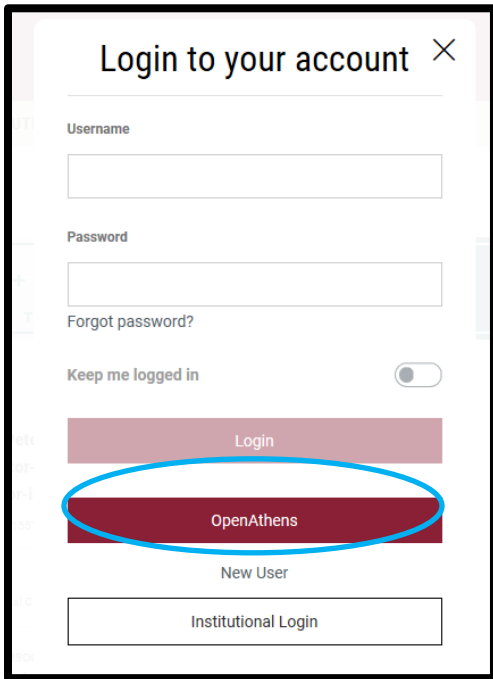
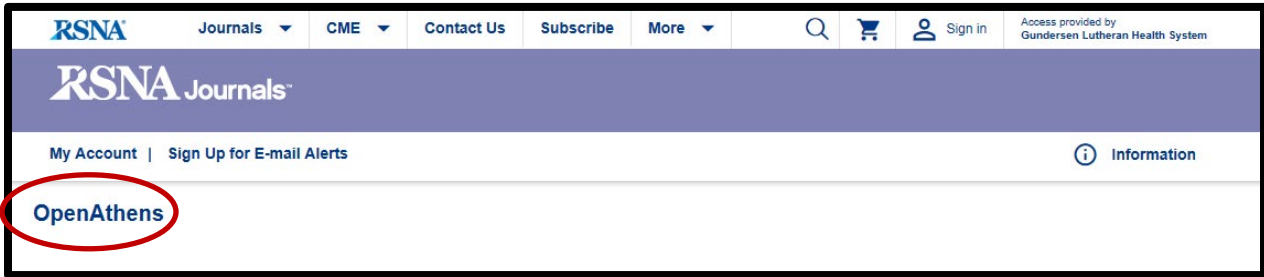

13. After clicking on an OpenAthens login link you will see the screen below. Search for Gundersen under Find your Organization/Institution. Click on the Gundersen Health System link.

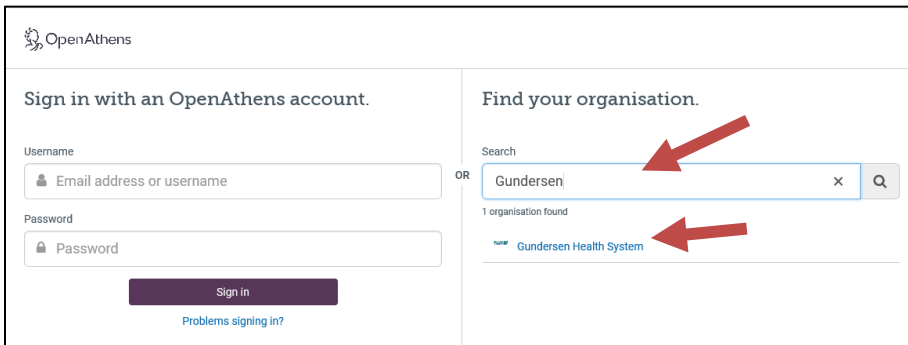

14. Click Gundersen Health System Current-Employees if you are a current, salaried employee. Sign in with your Gundersen email and current network password.
15. Click Open Athens-Sign in with an OpenAthens account if library staff assigned an OpenAthens account to you. Sign in with your OpenAthens username/password.

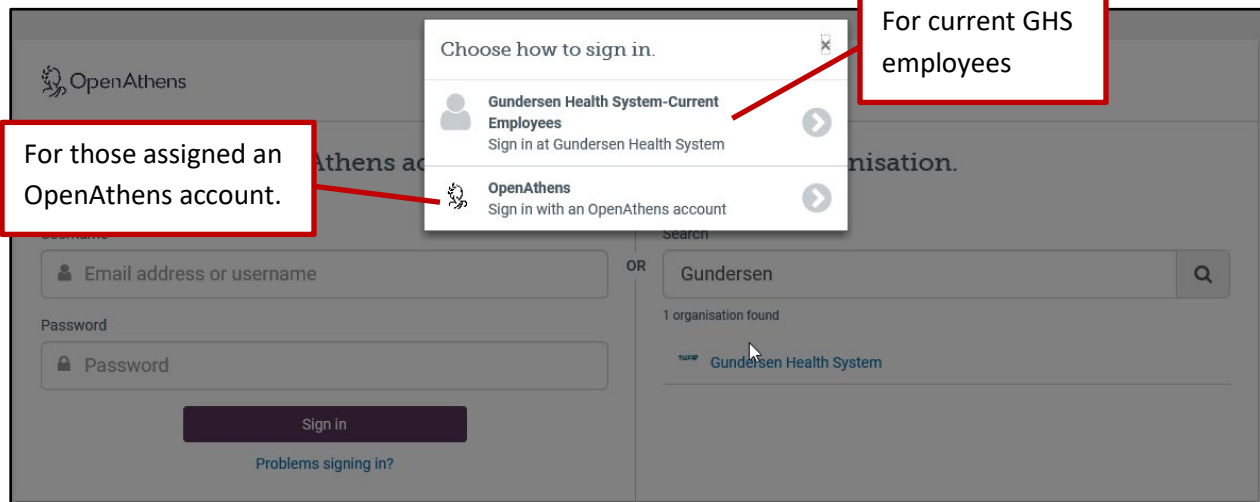

16. Once you have signed in via OpenAthens, you should be able to access the full-text of the journal of interest.

If you have any questions, please contact the library staff at [library@gundersenhealth.org](mailto:library@gundersenhealth.org) or 608-775-5410.